

CMU WALL KEY PLAN
 SCALE: N.T.S.
 REF: A2.01, A3.0 TO A3.2 & S2.01

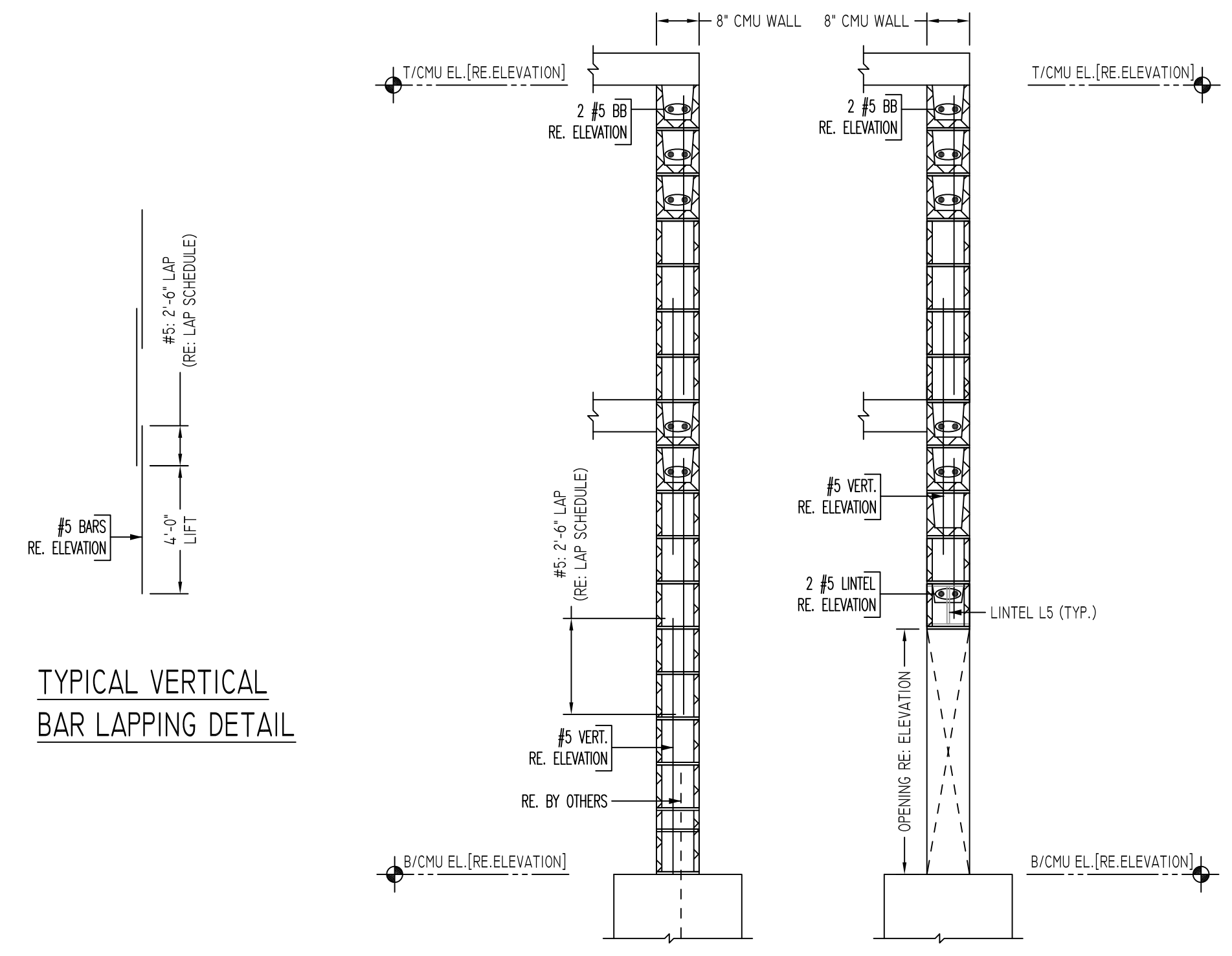

TYPICAL VERTICAL BAR LAPPING DETAIL

TYPICAL CMU WALL SECTION DETAILS

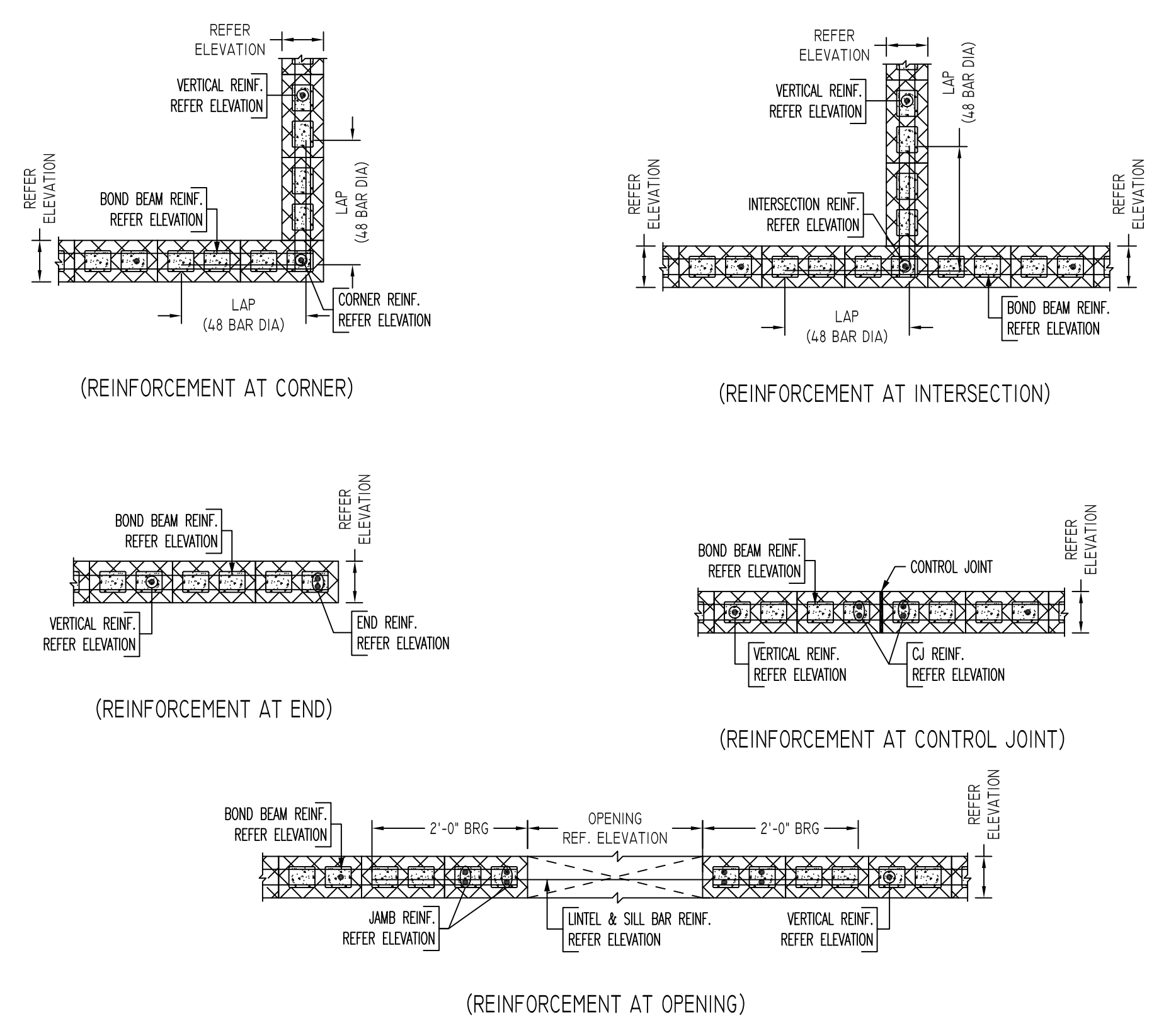

TYPICAL CMU WALL DETAILS

SCALE: 1/2" = 1'-0"
 REF: -
 A/E PLEASE VERIFY BAR ARRANGEMENT (TYP.)

| SIZE | L48 @ LAP |
|------|-----------|
| #3 | 18" |
| #4 | 24" |
| #5 | 30" |
| #6 | 36" |
| #7 | 42" |
| #8 | 48" |
| #9 | 54" |
| #10 | 60" |
| #11 | 66" |

| LEGEND | |
|-----------------|-------------|
| NO. OF LOCATION | NO. OF LIFT |
| NO. OF LIFT | NO. OF BARS |
| NO. OF LOCATION | NO. OF BARS |
| NO. OF LIFT | NO. OF BARS |
| NO. OF LOCATION | NO. OF BARS |
| NO. OF LIFT | NO. OF BARS |
| NO. OF LOCATION | NO. OF BARS |
| NO. OF LIFT | NO. OF BARS |

| Abbreviations: | |
|---------------------|---------------------------|
| I.F.=Inside Face | OPNG=Opening |
| O.F.=Outside Face | BAL=Balance |
| E.F.=Each Face | BTW=Between |
| DWL=Dowel | CJ=Construction Joint |
| V=Vertical | CLR=CLEARANCE |
| H=Horizontal | CMU=Concrete Masonry Unit |
| C.B.=Corner Bar | CONT.=Continuous |
| S.DWL.=Slab Dowel | EA.=Each |
| E.W.=Each Way | Elev.=Elevation |
| B/BOT.=Bottom | EMB.=Embedment |
| T=Top | SW.=Short Way |
| MDWL.=Masonry Dowel | LW.=Long Way |
| B.B.=Bond Beam | (BL)=Black Bar |
| ALT.=Alternate | (EP)=Epoxy Bar |
| Approx. Approximate | (GA)=Galvanized |

NOTICE
 Shortages, improper fabrication or claims for any other reason must be reported to this company within a period of 15 days of delivery. This company reserves the right to field inspect prior to replacement or reconditioning of nonconforming material, and will not honor charges for work done in the field without specific authorization from this company.
 REINFORCING STEEL PLACING DRAWINGS ONLY USE IN CONJUNCTION WITH CONTRACT DRAWINGS & SPECIFICATIONS. ELEVATIONS & DIMENSIONS SHOWN ON THIS DRAWING ARE FOR DETAILING PURPOSES ONLY AND SHOULD NOT BE USED FOR CONSTRUCTION UNLESS VERIFIED BY ENGINEER OR CONTRACTOR.

| REVISION MARK | REVISION DETAILS | DATE |
|---------------|------------------|------------|
| 0 | FOR APPROVAL | 10/22/2019 |

| | | | |
|----------------|---|-------|--------------|
| PROJECT | THE DIXWELL COMMUNITY CENTER - Q HOUSE | | |
| LOCATION | 197 DIXWELL AVENUE, NEW HAVEN, CT | | |
| ARCHITECT | KENNETH BOROSON ARCHITECT | | |
| ENGINEER | DIVERSIFIED TECHNOLOGY CONSULTANTS, INC | | |
| CUSTOMER | JOE CAPASSO MANSONS | | |
| DRAWN BY: | MRS | DATE: | 10/22/19 |
| REVIEWED BY: | T/L | DATE: | 10/22/19 |
| DRAWING TITLE: | CMU WALL REINFORCEMENT DETAILS | | DRAWING NO.: |
| | | | R01 |