

Release Number: RF-02A

| Bar Mark | Qty | Size | Total Length | Type | BENDING DETAILS | | | | | | | | | | | | | |
|----------|-----|------|--------------|------|-----------------|-------|--------|----|--------|-------|-------|----|-------|----|----|----|--------|--------|
| | | | | | X' | Y' | Z' | V' | T' | Y' | Z' | V' | T' | Y' | Z' | V' | | |
| 4B01 | 42 | #4 | 4'-0" | 17 | | 2'-0" | 2'-0" | | | | | | | | | | | |
| 4B02 | 108 | #4 | 5'-6" | 2 | | 0'-8" | 4'-10" | | | | | | | | | | | |
| 4B03 | 18 | #4 | 4'-10" | 25 | | 1'-8" | 0'-5" | | 0'-8" | 0'-5" | 1'-8" | | 0'-5" | | | | 0'-2 X | |
| 4B04 | 40 | #4 | 2'-6" | 17 | | 1'-3" | 1'-3" | | | | | | | | | | | |
| 4B05 | 8 | #4 | 4'-5 X | 3 | | 3'-3" | 0'-8 X | | | | | | | | | | 0'-6 X | 0'-6" |
| 4B06 | 14 | #4 | 7'-6" | 2 | | 0'-8" | 6'-10" | | | | | | | | | | | |
| 4B07 | 6 | #4 | 3'-6" | 17 | | 1'-0" | 2'-6" | | | | | | | | | | | |
| 4B08 | 12 | #4 | 5'-5 X | 20 | | 1'-0" | 2'-0" | | 2'-5 X | | | | | | | | 1'-6 X | 2'-0 X |
| 4B09 | 6 | #4 | 2'-8 X | 3 | | 0'-7" | 2'-1 X | | | | | | | | | | 1'-6 X | 2'-0 X |

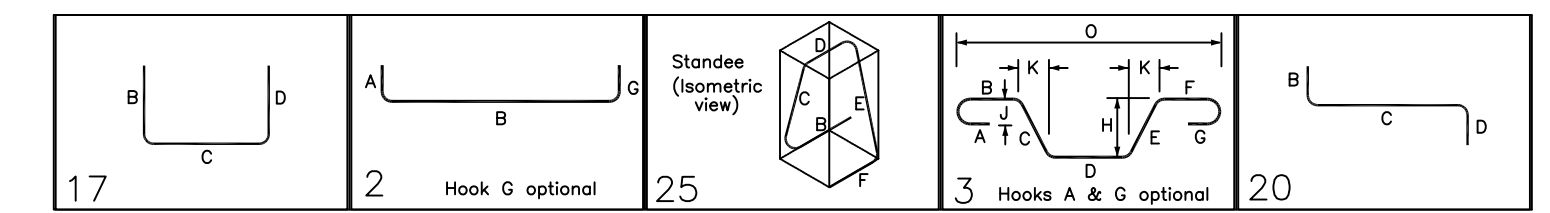

FOR ELEVATOR PIT REINFORCEMENT DETAILS REFER DRAWING RF-02 & RF-02A

TYPICAL REINFORCING BAR CLEARANCE TABLE

| LOCATION | MIN. COVER |
|---------------------------|------------|
| FOR FOOTING BOTTOM & SIDE | 3" CLR |
| FOR FOOTING TOP | 2" CLR |
| FOR FOOTING SIDE & TOP | 2" CLR |

**ALL BARS IN THIS DRAWING
ASTM A615 GRADE 60
BLACK UNCOATED**

LAP SCHEDULE

| SIZE | 3000 PSI | |
|------|----------|--------|
| | TOP | OTHERS |
| #3 | 28" | 22" |
| #4 | 37" | 29" |
| #5 | 47" | 36" |
| #6 | 56" | 43" |

ENG. PLEASE VERIFY THE LAP SCHEDULE

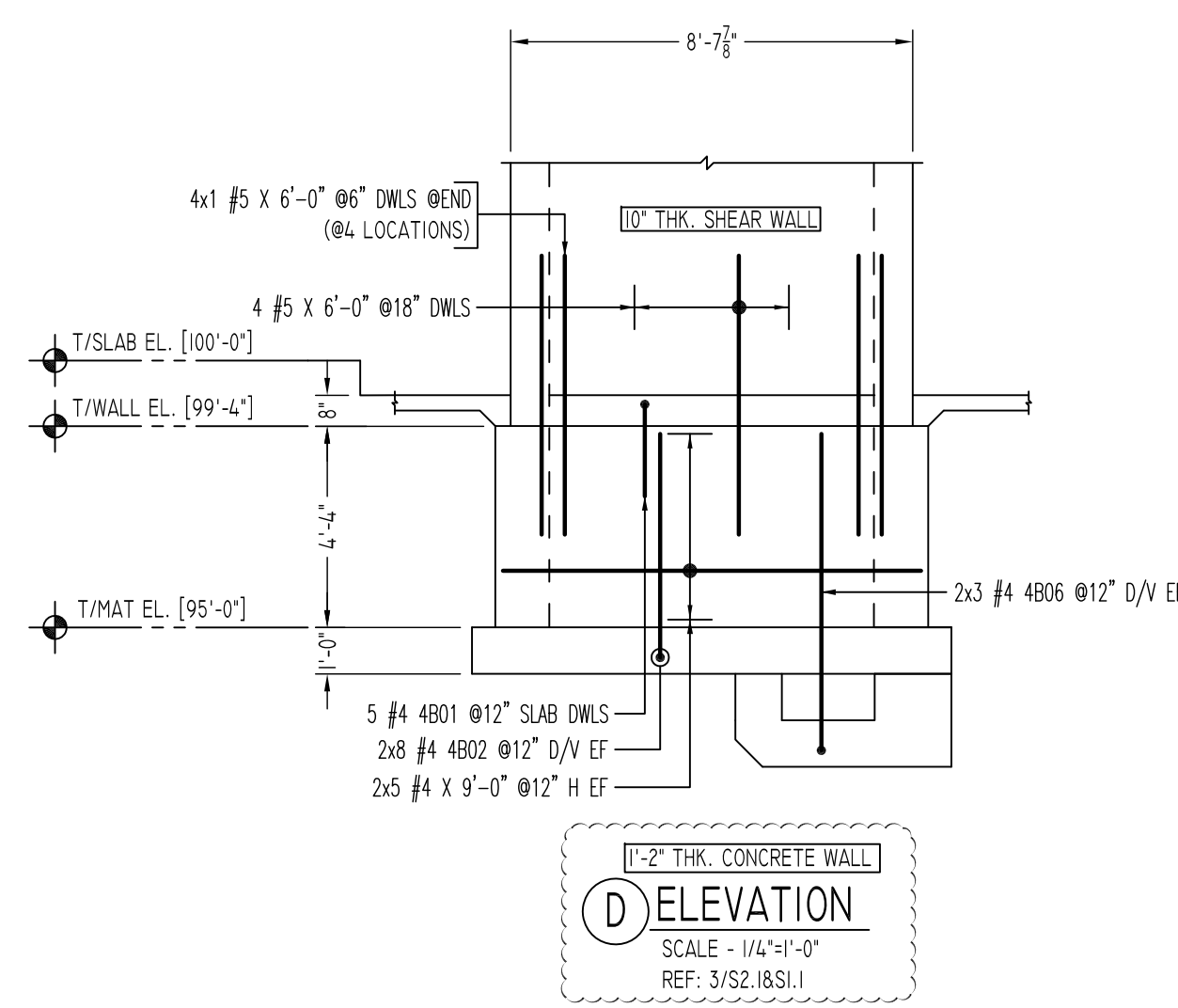
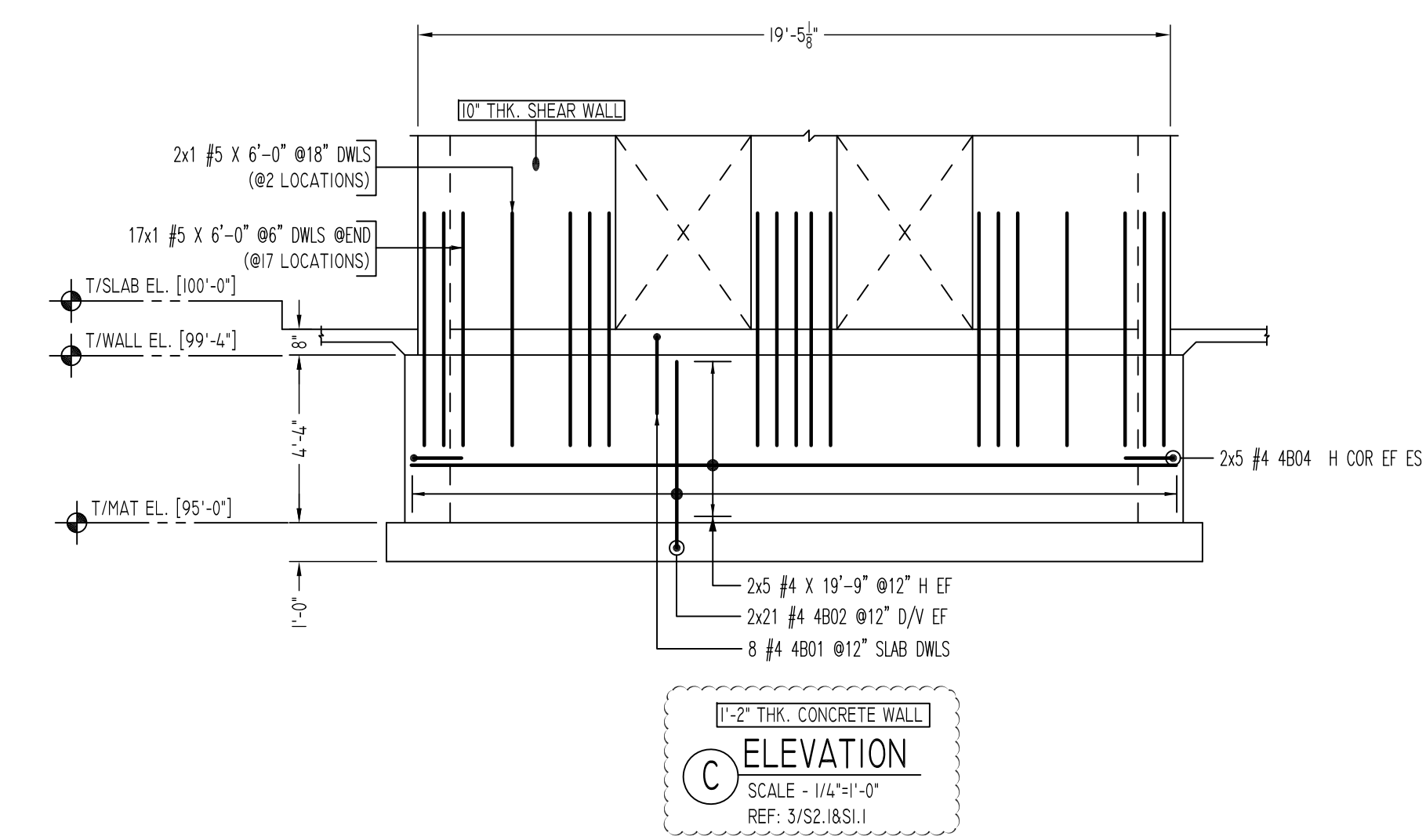

Abbreviations:
I.F.=Inside Face
O.F.=Outside Face
E.F.=Each Face
CJ=Construction Joint
CLR=CLEARANCE
H=Horizontal
C.B.=Corner Bar
S.DWL=Slab Dowel
E.W.=Each Way
B/BOT.=Bottom
T=Top
MDWL=Masonry Dowel
B.B.=Bond Beam
ALT.=Alternate
Approx.=Approximate

OPNG=Opening
BAL=Balance
BTW=Between
CJ=Construction Joint
CLR=CLEARANCE
CMU=Concrete Masonry Unit
CONT.=Continuous
EA=Each
Elev.=Elevation
EMB=Embedment
SW=Short Way
LW=Long Way
(BL)=Black Bar
(EP)=Epoxy Bar
(GA)=Galvanized

NOTICE

Shortages, improper fabrication or claims for any other reason must be reported to this company within a period of 15 days of delivery. This company reserves the right to field inspect prior to replacement or reconditioning of nonconforming material, and will not honor charges for work done in the field without specific authorization from this company.

REINFORCING STEEL PLACING DRAWINGS ONLY USE IN CONJUNCTION WITH CONTRACT DRAWINGS & SPECIFICATIONS. ELEVATIONS & DIMENSIONS SHOWN ON THIS DRAWING ARE FOR DETAILING PURPOSES ONLY AND SHOULD NOT BE USED FOR CONSTRUCTION UNLESS VERIFIED BY ENGINEER OR CONTRACTOR.

| REVISION MARK | REVISION DETAILS | DATE |
|---------------|------------------|------------|
| 0 | FOR APPROVAL | 03/24/2022 |

| | | | |
|----------------|------------------------------------|----------|--------------|
| PROJECT | RESIDENCE INN, MARRIOTT HYDE PARK | | |
| LOCATION | HYDE PARK, NEW YORK | | |
| ARCHITECT | ZHA ARCHITECTS, PC | | |
| ENGINEER | EHLERT/BRYAN, INC. | | |
| CUSTOMER | PC CONSTRUCTION | | |
| DRAWN BY: | RTP/MRS | DATE: | 03/24/22 |
| REVIEWED BY: | T/L | JOB NO.: | 22015 |
| DRAWING TITLE: | ELEVATOR PIT REINFORCEMENT DETAILS | | DRAWING NO.: |
| | | | RF-02A |