

**SITE WORK REINFORCEMENT DETAILS**  
 REF:A1.04  
 SCALE: 1/16" = 1'-2"

**LEGEND:**  
 SCREEN WALL (TYP.)

**ALL BARS IN THIS DRAWING  
 ASTM A615 GRADE 60  
 BLACK UNCOATED**

**TYPICAL REINFORCING BAR CLEARANCE TABLE**

LOCATION	MIN. COVER
WALL TOP	2" CLR
WALL SIDE	2" CLR

**LAP SCHEDULE**  
 Per ACI :318 (12.2.2)

BAR#	LENGTHS
#3	2'-0"
#4	2'-0"
#5	2'-1"
#6	2'-6"
#7	2'-11"
#8	3'-4"
#9	3'-10"
#10	4'-3"
#11	4'-9"

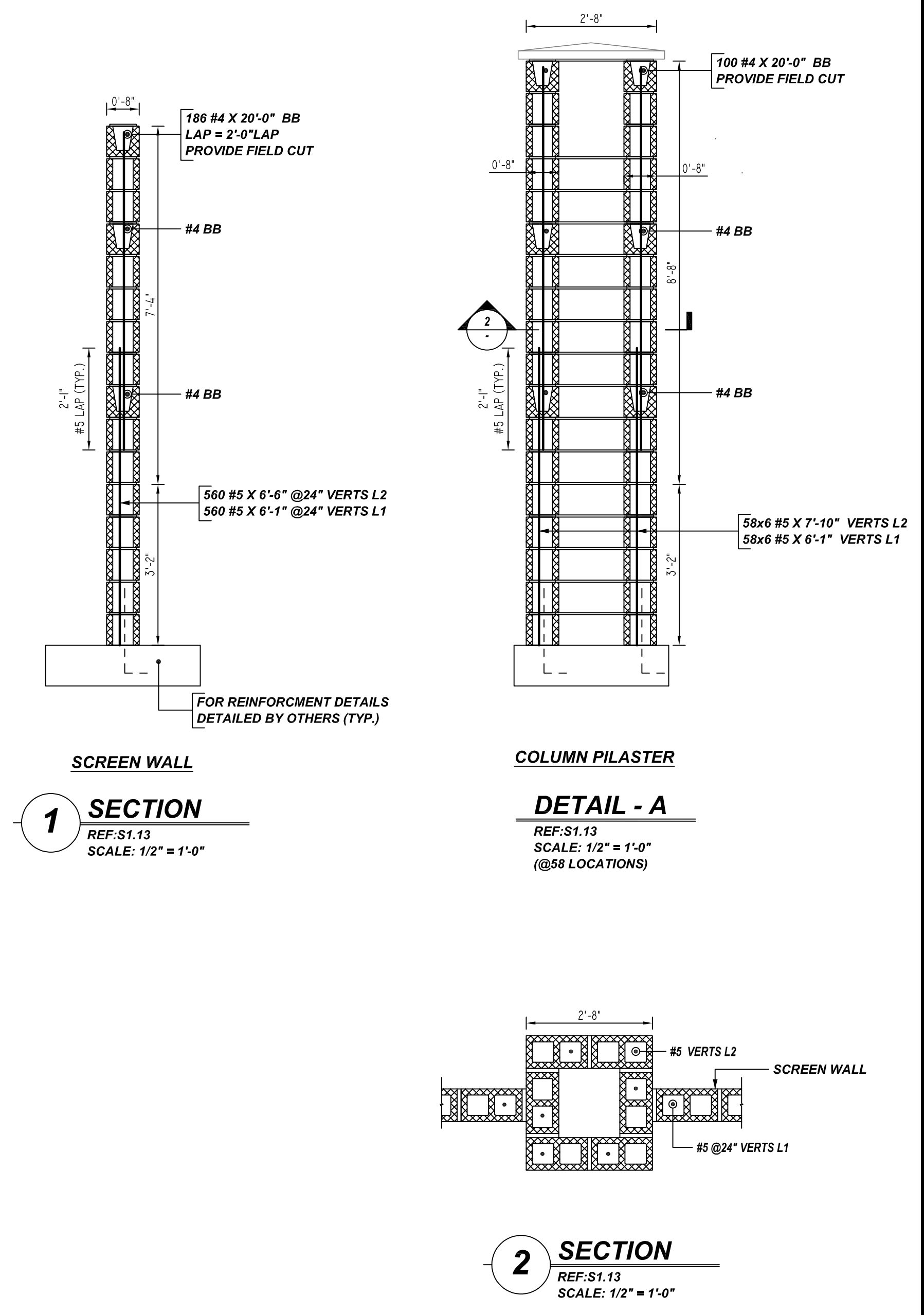
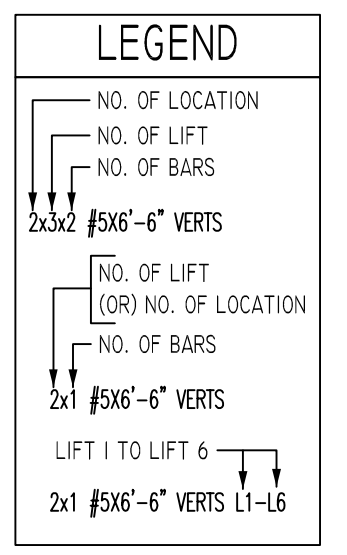

- PLACING PLAN NOTES**
1. THIS DRAWINGS FOR REBAR PLACEMENT ASSISTANCE ONLY, REFER TO STRUCTURAL DETAILS FOR CONTRACT REQUIREMENTS
  2. SECTIONS / DETAILS / DIMENSIONS ON PLACING PLAN ARE FOR REFERENCE AND ARE TO BE USED IN CONJUNCTION WITH CONTRACT DRAWINGS FOR CRSI MANUAL OF STANDARD PRACTICE
  3. REINFORCING STEEL IS DETAILED PER CONTRACT DOCUMENTS ONLY AS SHOWN CODE COMPLIANCE REQUIREMENTS ARE THE RESPONSIBILITY OF ENGINEER AND / OR CONTRACTOR
  4. THE CONTRACTORS UNDERSTANDS THAT THE ENGINEER SHOULD ALWAYS VERIFY SHOP DRAWINGS IF TIME DOES NOT ALLOW FOR APPROVALS, TEXAS REBAR IS NOT HELD RESPONSIBLE FOR UNAPPROVED SHOP DRAWINGS USED IN PLACING CRSI MANUAL OF STANDARD PRACTICE THE CUSTOMER AND ENGINEER SHOULD REVIEW SHOP DRAWINGS PRIOR TO INSTALLATION TO VERIFY ACCURACY TO STRUCTURAL DRAWINGS.
- PLACING PLAN NOTES**
1. DIMENSIONS ELEVATIONS & DRAWINGS GRADES SHOWN ARE FOR REFERENCE ONLY CONTRACTOR TO PROVIDE LINES, GRADES & TEMPLATES REQUIRED FOR PLACEMENTS
  2. SECTIONS & DETAILS MAY NOT BE SHOWN ON ALL PLACING PLANS. KEEP STRUCTURAL DRAWINGS ON SITE FOR USE
  3. SOME LAP LENGTHS WILL BE ROUNDED UP IN DETAILING TO PROVIDE FOR 1" INCREMENTS FOR LAPS
  4. LAP OR EMBEDMENT LENGTHS SHOWN IN SPECIFIC DETAILS WILL SUPPRESS LAPS IN THE LAP SCHEDULE
  5. VERIFY PLACEMENT DRAWINGS TO LATEST ISSUE OF JOB RECORD DRAWING FOR POSSIBLE REVISIONS OR FIELD CHANGES
  6. TYPICAL NOTES & DETAILS ARE USED THROUGHOUT ENTIRE PROJECT & APPLY UNLESS NOTED OTHERWISE.

NO.	REVISION	DATE	DESCRIPTION	BY	CHECKED	DATE	JOB NAME:	JOB NO:	DETAILS OF:	DATE:	DETAILER:	DRWG:

NORTHWEST BOOSTER PUMP STATION  
 22097  
 SITE WORK REINFORCEMENT DETAILS  
 SSTR  
 M06  
 TEXAS REBAR, LLC 817-487-1672