

PAPER PIT FOUNDATION REINFORCEMENT DETAILS

SCALE: 1/4" = 1'-0"
REF: P202676 (DT.01/14/22)

Release Number: R-003

Bar Mark	Qty	Size	Total Length	Type	X	Y	Z	W	V	U	T	S	R	Q	P	O	N	M	L	K	J	I	H	G	F	E	D	C	B	A
4501	150	#4	4'-11" 2/5																											

**ALL BARS IN THIS DRAWING
ASTM A615 GRADE 60
BLACK UNCOATED**

TYPICAL REINFORCING BAR CLEARANCE TABLE

LOCATION	MIN. COVER
SLAB SIDE & BOTTOM	3" CLR
SLAB TOP	2" CLR
WALL OF & TOP	2" CLR
WALL IF	1 1/2" CLR

LAP SCHEDULE
3000 PSI (CLASS-B) CASE - 1
Per ACI 318 (12.2.2)

BAR#	LENGTHS	
	TOP	OTHERS
#3	2'-4"	1'-10"
#4	3'-1"	2'-5"
#5	3'-11"	3'-0"
#6	4'-8"	3'-7"
#7	6'-9"	5'-3"
#8	7'-9"	6'-0"
#9	8'-9"	6'-9"
#10	9'-10"	7'-7"
#11	10'-11"	8'-5"

ALL TOP BARS ARE DEFINED AS HORIZ BARS WITH MORE THAN 12" OF CONCRETE BELOW BARS.

A/E PLEASE VERIFY THE LAP SCHEDULE

- PLACING PLAN NOTES:**
- THIS DRAWING IS FOR REBAR PLACEMENT ASSISTANCE ONLY; REFER TO STRUCTURAL DETAILS FOR CONTRACT REQUIREMENTS.
 - SECTIONS/DETAILS/DIMENSIONS ON PLACING PLAN ARE FOR REFERENCE ONLY AND ARE TO BE USED IN CONJUNCTION WITH CONTRACT DRAWINGS PER CRSI MANUAL OF STANDARD PRACTICE.
 - REINFORCING STEEL IS DETAILED PER CONTRACT DOCUMENTS ONLY AS SHOWN. CODE COMPLIANCE REQUIREMENTS ARE THE RESPONSIBILITY OF ENGINEER AND/OR CONTRACTOR.
 - THE CONTRACTOR(S) UNDERSTANDS THAT THE ENGINEER SHOULD ALWAYS VERIFY SHOP DRAWINGS. IF TIME DOES NOT ALLOW FOR APPROVALS, P.T.S IS NOT HELD RESPONSIBLE FOR UNAPPROVED SHOP DRAWINGS USED IN PLACING (CRSI MANUAL OF STANDARD PRACTICE). THE CUSTOMER AND ENGINEER SHOULD REVIEW SHOP DRAWINGS PRIOR TO INSTALLATION TO VERIFY ACCURACY TO STRUCTURAL DRAWINGS.

- PLACING NOTES:**
- DIMENSIONS, ELEVATIONS & DRAWING SCALES SHOWN ARE FOR REFERENCE ONLY. CONTRACTOR TO PROVIDE LINES, GRADES & TEMPLATES REQUIRED FOR PLACEMENT.
 - SECTIONS & DETAILS MAY NOT BE SHOWN ON ALL PLACING PLANS. KEEP STRUCTURAL DRAWINGS ON SITE FOR USE.
 - SOME LAP LENGTHS WILL BE ROUNDED UP IN DETAILING TO PROVIDE FOR 1" INCREMENTS FOR LAPS.
 - LAPS OR EMBEDMENT LENGTHS SHOWN IN SPECIFIC DETAILS WILL SUPERSEDE LAPS IN THE LAP SCHEDULE.
 - MILL CERTIFICATIONS ARE REQUIRED FOR ALL SHIPMENTS. IF BARS CANNOT BE IDENTIFIED, SPECIAL TESTING MAY BE DONE WITH SAMPLES CUT FROM SHIPMENT.
 - VERIFY PLACEMENT DRAWINGS TO LATEST ISSUE OF JOB RECORD DRAWINGS FOR POSSIBLE REVISIONS OR FIELD CHANGES.
 - TYPICAL NOTES & DETAILS ARE USED THROUGHOUT ENTIRE PROJECT & APPLY UNLESS NOTED OTHERWISE.

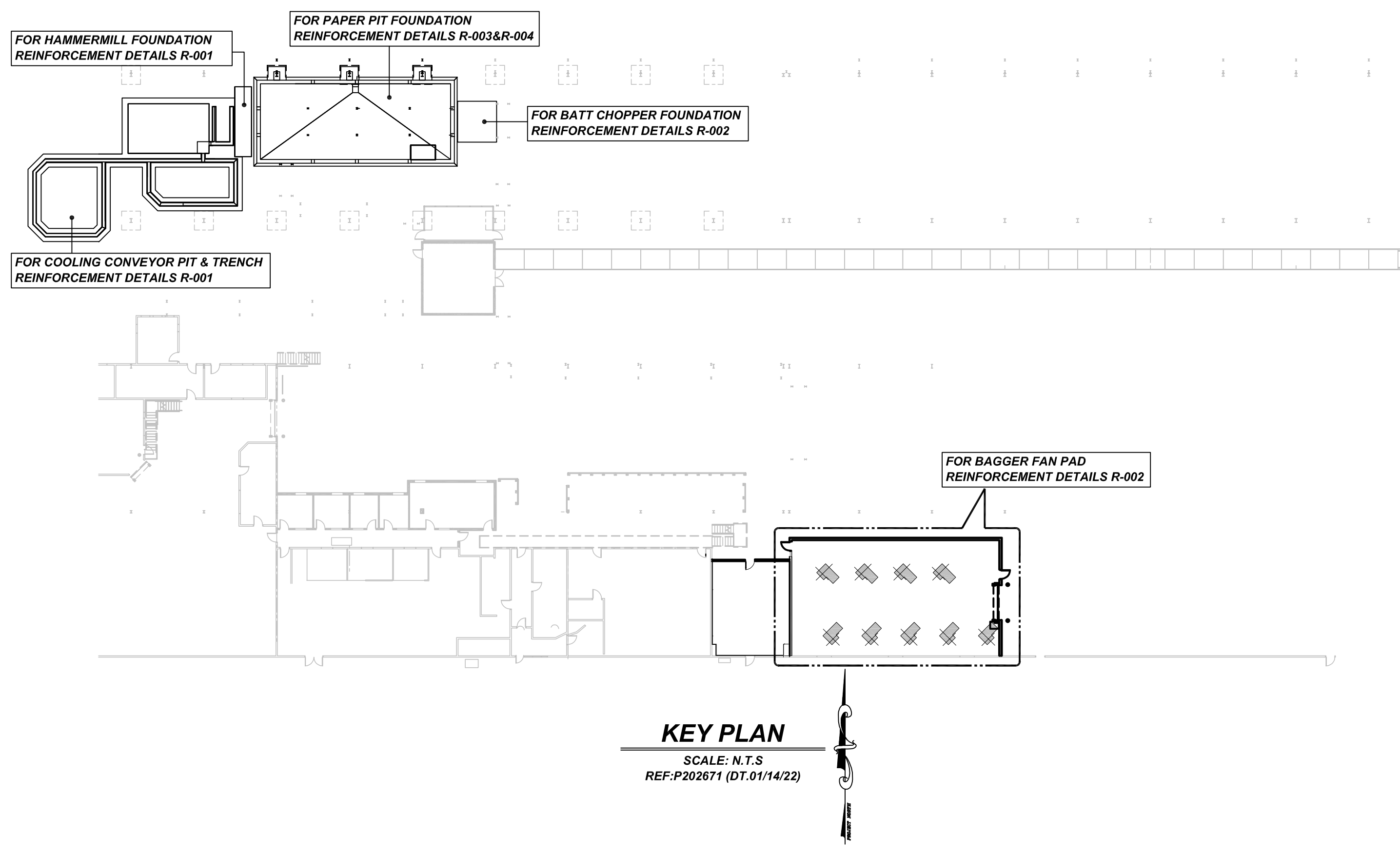

KEY PLAN
SCALE: N.T.S.
REF: P202671 (DT.01/14/22)

REBAR GRADE
ASTM A615 GRADE 60
PRE-FIX: B

DATE	REVISION
09/14/2022	REVISED & RE-SUBMITTED
	REVISION FOR CONSTRUCTION PER CUSTOMER'S REQUEST

TITLE: PAPER PIT, MAT FOUNDATION, PILLARS, WALLS & SLAB REINFORCING DETAILS
PROJECT: NEPHI UT CONTRACT #16
LOCATION: NU, NEPHI UT
CUSTOMER:
DRAWN BY: RTP DATE: 09/14/2022 CHKD BY: MET

JOB # 78410
DWG # R-003

